

# 1

# HYDRAULIC POWER UNITS

## INDUSTRIAL BRAKES QS SERIES

# 1.0 Hydraulic power unit models

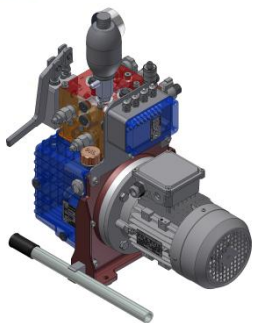

**HPT04-DBQS**

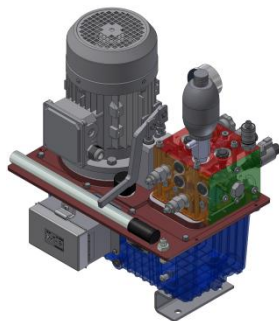

**HPT08-DBQS**

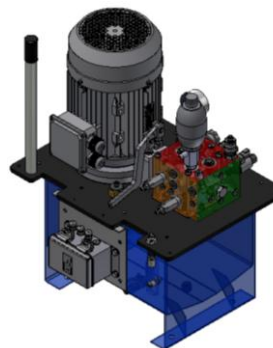

**HPT20-DBQS**

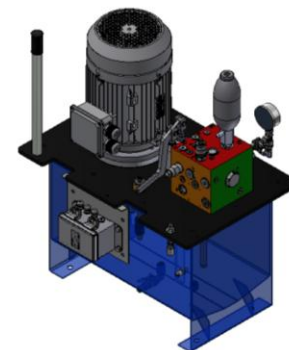

**HPT40-DBQS**



**HTP04  
DCQSS4EN**

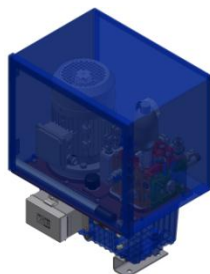

**HPT08  
DCQSS4EN**

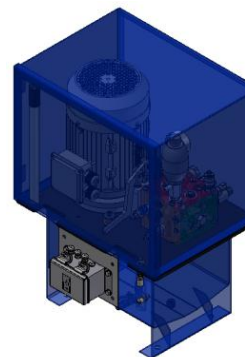

**HPT20  
DBQSS4EN**

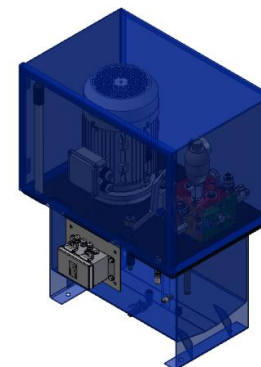

**HPT40  
DBQSS4EN**

## 2.0 Hydraulic power unit manifold models

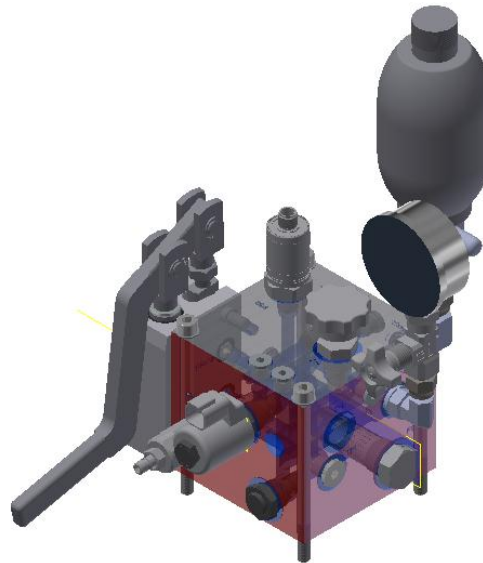

**MB1V3**

**Hillmar manifolds are manufactured standard in aluminum**

## 3.0 Principle of Operations

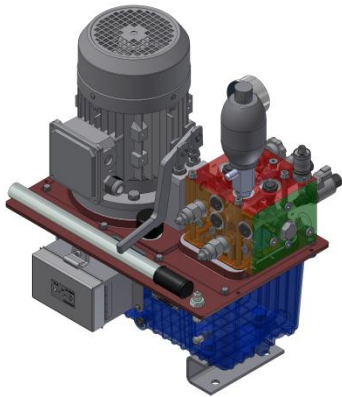

DCQS model

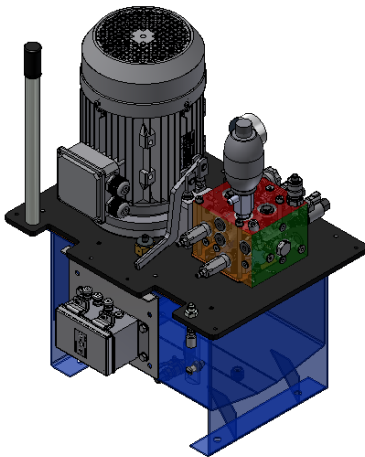

SSQS model

- All HPT system components are modular and easy field replaceable.
- Each HPT hydraulic system is supplied standard as a non-constant running system.
- Available in 5 size hydraulic systems 3 DC & 2 SS models.
- The hydraulic power unit runs until signal from either a pressure switch or proximity switch tells it to stop.
- The unit will remain shut down until internal system leakage reduces the system pressure thus activating an electrical signal to recharge the system.
- It should be noted that during operation system pressure is never allowed to drop below the minimum system release pressure.
- The QS series of hydraulic power units has been designed specifically for use with industrial (emergency) disc brakes.

## 4.0 Design Highlights

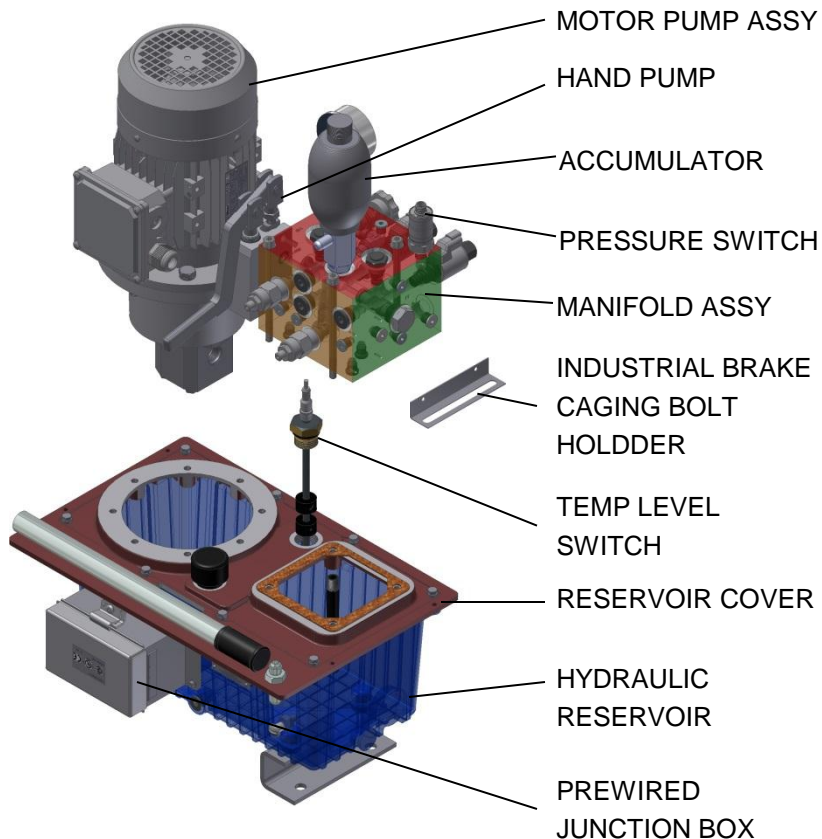

- All hydraulic components are field replaceable without having to remove reservoir.
- Stainless steel (304) reservoir on 20 and 40 liter models.
- All fasteners stainless steel (304) standard.
- Hand pump design for product manual release.
- All reservoirs standard with V-bottom.
- All hydraulic hose comes complete with type & date marks.
- High pressure filter with replaceable field element.
- System components standard from brand name manufacturers.
- Bracket for industrial brake caging bolts.



## 5.0 Standard Features

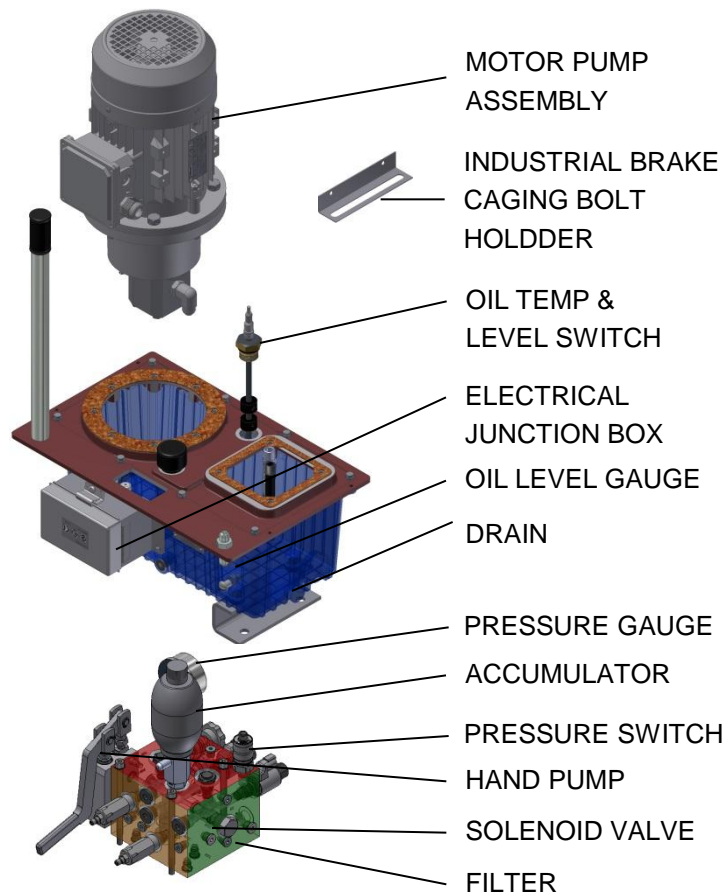

- Hand pump for manual release.
- Solenoid valve with LED indicator.
- Stainless steel (304) reservoir on 20L & 40L models.
- Stainless steel (304) fasteners.
- IP55 rated electrical motor & junction box.
- All system components designed for maximum 20MPa operating pressure.
- Reservoir accessories standard including:
  - ❖ Oil temperature level switch.
  - ❖ Oil level Gauge.
  - ❖ High pressure filter.
  - ❖ Drain reservoir shut off valve.
  - ❖ Pressure switch.
  - ❖ Accumulator.
  - ❖ Pressure Gauge.
  - ❖ All components field replaceable.

## 6.0 Design Options



- Stainless steel (304) enclosure
- Oil drip pans
- Hose and fitting kits
- CSA certification or CSA ready
- Explosion proof
- Reservoir heater
- Motor strip heater
- Stainless steel junction box upgrade
- Weather stripping
- Non standard voltages
- Custom paint colors
- Custom electrical configuration

## 7.0 Standards

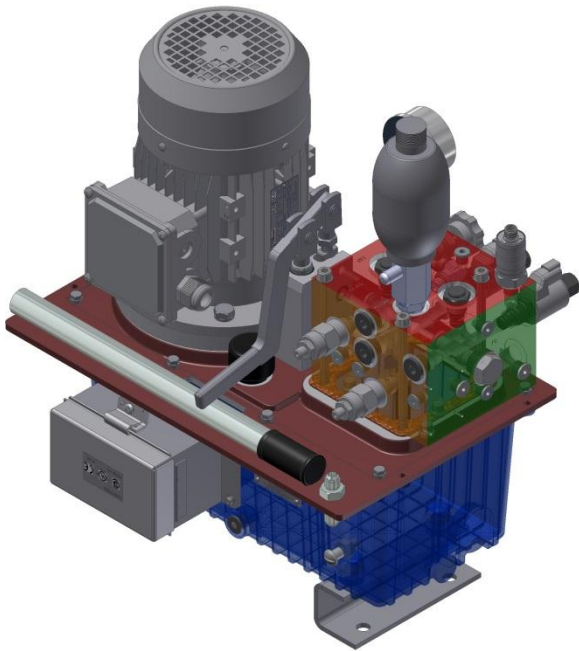

All Hillmar products are designed & manufactured in accordance with the following standards.

- 7.1 Design standards.
- 7.2 Performance standards.
- 7.3 Document standards.
- 7.4 Production & Quality standards.
- 7.5 Packaging standards.

All Hillmar products are delivered with Hillmar commitment to customer satisfaction.

All Hillmar products manufactured in accordance with DIN 10204-2.1

Hillmar is an ISO 9001:2008 certified company.